

# Fairfax Century 21 Mastracorp Commercial

Fairfax Century 21 Mastracorp Commercial (ELIZABETH WEST)  
46 Phillips Highway, ELIZABETH WEST SA

## Property Area

Building Area :	-
Land Area :	4601 Square Metres
Hardstand :	-
Car :	-

## Tenancy Details

### Tenancy :

Office Showroom :	-
Mezzanine :	- Square Metres
Warehouse :	-
Other :	-
Total Floor Area :	- Square Metres

## Rentals Detail

Annual Rental :	-
Rate per sqm :	-
Lease Term :	-
Rent Review :	-
Outgoings :	Paid by Tenant
Currently Tenanted :	No
Zoning :	-

## Description & Comments :

Land Area:4,601 m<sup>2</sup> Occupancy:vacant possession Sale Price: Currently there is a development lodged with council \_ please call me on 0409465863 for update - Total Site Area is approximately 4,601 sqm - Corner allotment frontage to Philip Highway and Ridley Road - All desired and essential urban services are available to the subject property - Excellent exposure to passing traffic and ready access via the side street frontage. - The recent redevelopment of Elizabeth City Centre has improved the profile of the locality. - Quality investment property! INSPECTION A MUST!

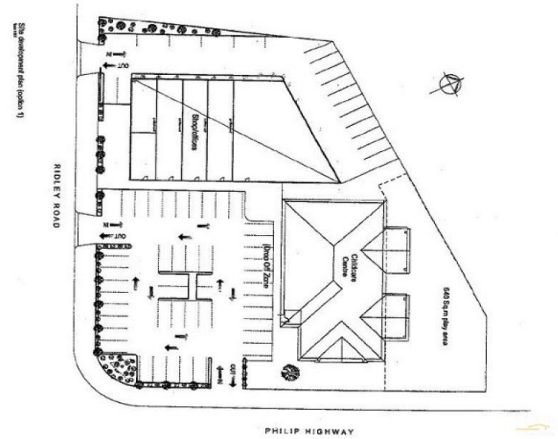

## Contacts

**Pasquale Mastrangelo**  
pasquale@mastracorp.com.au

## All Prices are exclusive of GST

Disclaimer. Information in this document may have been provided to Fairfax Century 21 Mastracorp Commercial Adelaide by other people and we don't warrant it is accurate or correct. Figures quotes are approximate only and financial information is provided without reference to the possible Impact of GST. Interested parties should make their own enquires and seek independent advice before acting. Subject and statutory limitation on it's ability to do si, Fairfax Century 21 Mastracorp

# Fairfax Century 21 Mastracorp Commercial

**Fairfax Century 21 Mastracorp Commercial (WINGFIELD)**  
146-148 Francis Street, WINGFIELD SA

## Property Area

Building Area : -  
Land Area : 7800 Square Metres  
Hardstand : -  
Car : -

## Tenancy Details

### Tenancy :

Office Showroom : -  
Mezzanine : 1200 Square Metres  
Warehouse : -  
Other : -  
Total Floor Area : 1200 Square Metres

## Rentals Detail

Annual Rental : -  
Rate per sqm : -  
Lease Term : -  
Rent Review : -  
Outgoings : Paid by Tenant  
Currently Tenanted : No  
Zoning : -

## Description & Comments :

Warehouse/Workshop/Office 2 separate titles 3 buildings on site Site area 7,800m2  
approx Corner location Ten year lease from 1/7/07 Current net rental \$421,000 per  
annum NET RETURN



## Contacts

**Pasquale Mastrangelo**  
pasquale@mastracorp.com.au

**All Prices are exclusive of GST**

# Fairfax Century 21 Mastracorp Commercial

**Fairfax Century 21 Mastracorp Commercial (MAGILL)**  
562 Magill Road, MAGILL SA

## Property Area

Building Area :	-
Land Area :	2305 Square Metres
Hardstand :	-
Car :	-

## Tenancy Details

### Tenancy :

Office Showroom :	-
Mezzanine :	556 Square Metres
Warehouse :	-
Other :	-
Total Floor Area :	556 Square Metres

## Rentals Detail

Annual Rental :	-
Rate per sqm :	-
Lease Term :	-
Rent Review :	-
Outgoings :	Paid by Tenant
Currently Tenanted :	No
Zoning :	-

## Description & Comments :

Fully leased to 3 secure tenants, located in a very busy, highly sought after area! With frontage to Magill Road, and Penfold Road the property boasts a large carpark at rear, fantastic main road frontage and excellent future development potential (stcc) The key features include: - Building improvements of 556sqm (approx) - Frontage and access from Magill Road and Penfold Road - Substantial land holding of 2,305sqm (approx) across 3 titles - Fully leased to 3 Quality Tenants - Ample parking at rear - Further development potential (stcc) and rental upside - Prime location in a well established and vibrant precinct For more information, please contact the agent for an Information Memorandum with all lease particulars and appendices.



## Contacts

**Pasquale Mastrangelo**  
pasquale@mastracorp.com.au

Disclaimer. Information in this document may have been provided to Fairfax Century 21 Mastracorp Commercial Adelaide by other people and we don't warrant it is accurate or correct. Figures quotes are approximate only and financial information is provided without reference to the possible Impact of GST. Interested parties should make their own enquires and seek independent advice before acting. Subject and statutory limitation on it's ability to do si, Fairfax Century 21 Mastracorp Commercial disclaims liability under any cause of action including negligence for any loss arising from reliance upon this document. This document is nnot an offer or part of a contract of sale or lease.

# Fairfax Century 21 Mastracorp Commercial

**Fairfax Century 21 Mastracorp Commercial (HOLDEN HILL)**  
598 - 600 North East Road, HOLDEN HILL SA

## Property Area

Building Area : -  
Land Area : 1450 Square Metres  
Hardstand : -  
Car : -

## Tenancy Details

### Tenancy :

Office Showroom : -  
Mezzanine : 100 Square Metres  
Warehouse : -  
Other : -  
Total Floor Area : 100 Square Metres

## Rentals Detail

Annual Rental : -  
Rate per sqm : -  
Lease Term : -  
Rent Review : -  
Outgoings : Paid by Tenant  
Currently Tenanted : No  
Zoning : -

## Description & Comments :

STRATEGIC HIGH STREET LOCATION - LAND: Lot 48 (697m2) \$470,000 - LOT 49 (752m2) \$490,000 Total of 1450 sqm Vendor will consider all offers - Land development - Vacant Possession



## Contacts

**Pasquale Mastrangelo**  
pasquale@mastracorp.com.au

## All Prices are exclusive of GST

Disclaimer. Information in this document may have been provided to Fairfax Century 21 Mastracorp Commercial Adelaide by other people and we don't warrant it is accurate or correct. Figures quotes are approximate only and financial information is provided without reference to the possible impact of GST. Interested parties should make their own enquires and seek independent advice before acting. Subject and statutory limitation on its ability to do so, Fairfax Century 21 Mastracorp Commercial disclaims liability under any cause of action including negligence for any loss arising from reliance upon this document. This document is not an offer or part of a contract of sale or lease.

# Fairfax Century 21 Mastracorp Commercial

**Fairfax Century 21 Mastracorp Commercial (TAPEROO)**  
51-61 Gedville Road, TAPEROO SA

## Property Area

Building Area :	-
Land Area :	5438 Square Metres
Hardstand :	-
Car :	-

## Tenancy Details

### Tenancy :

Office Showroom :	-
Mezzanine :	1789 Square Metres
Warehouse :	-
Other :	-
Total Floor Area :	1789 Square Metres

## Rentals Detail

Annual Rental :	-
Rate per sqm :	-
Lease Term :	-
Rent Review :	-
Outgoings :	Paid by Tenant
Currently Tenanted :	No
Zoning :	-

## Description & Comments :

A neglected site that awaits an astute investor! The community is screaming for a local shopping centre that can offer a variety of goods and services. Secure a supermarket 'anchor' tenant, lease the remaining shops that will feed off the supermarket's high traffic flow and reap the benefits of a diversified income stream whilst simultaneously satisfying the local residence need for such a centre. - 6 Retail shops + 3 Offices + Freshly Renovated Vacant Supermarket (4 shops leased, vacant 600sqm Supermarket + 2 vacant retail shops + 3 vacant offices) - Freshly renovated supermarket (600sqm+) with new ducted aircon throughout, large storage freezer, 14 door display fridges, butcher/meat room, two offices, lunch room + a complete operating fit-out- Removable items such as box crusher, quick bake oven, cash register system, baker/ butcher equipment, ect available separately. - Zone: Local Centre Zone - Land: 5438m2 - Endless future development potential (stcc) - For full I.M an...

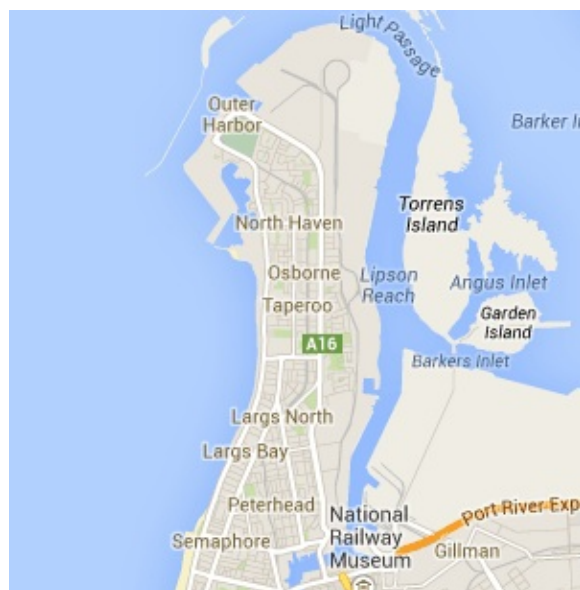

## Contacts

**Nicolas Mastrangelo**  
nick@mastracorp.com.au

## All Prices are exclusive of GST

Disclaimer. Information in this document may have been provided to Fairfax Century 21 Mastracorp Commercial Adelaide by other people and we don't warrant it is accurate or correct. Figures quotes are approximate only and financial information is provided without reference to the possible impact of GST. Interested parties should make their own enquires and seek independent advice before acting. Subject and statutory limitation on it's ability to do si, Fairfax Century 21 Mastracorp Commercial disclaims liability under any cause of action including negligence for any loss arising from reliance upon this document. This document is nnot an offer or part of a contract of sale or lease.

# Fairfax Century 21 Mastracorp Commercial

**Fairfax Century 21 Mastracorp Commercial (KURRALTA PARK)**  
131 Anzac Highway, KURRALTA PARK SA

## Property Area

Building Area :	-
Land Area :	1520 Square Metres
Hardstand :	-
Car :	6

## Tenancy Details

### Tenancy :

Office Showroom :	-
Mezzanine :	1520 Square Metres
Warehouse :	-
Other :	-
Total Floor Area :	1520 Square Metres

## Rentals Detail

Annual Rental :	-
Rate per sqm :	-
Lease Term :	-
Rent Review :	-
Outgoings :	Paid by Tenant
Currently Tenanted :	No
Zoning :	-

## Description & Comments :

Conveniently located close to both inner- city Adelaide and the popular Glenelg Seashore. Renovation and upgrading of facilities now has (a total of 17 rooms) Each room comprises the following: -New split a/c, bed and mattress and wardrobe, Study-desk and chair, Phone line: -ADSL2 Wireless internet connection and coin operated laundry are available on site. -potential weekly rental earnings ( starting from \$150 pw )

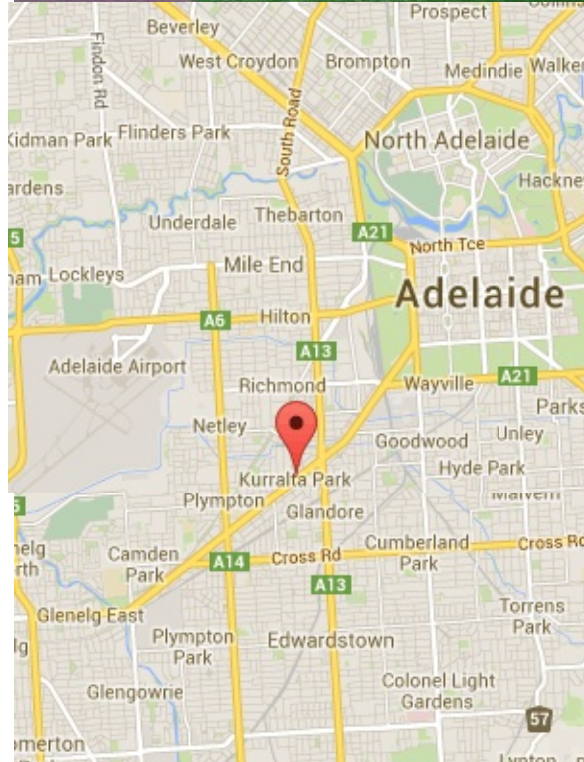

## Contacts

**Pasquale Mastrangelo**

[pasquale@mastracorp.com.au](mailto:pasquale@mastracorp.com.au)

## All Prices are exclusive of GST

Disclaimer. Information in this document may have been provided to Fairfax Century 21 Mastracorp Commercial Adelaide by other people and we don't warrant it is accurate or correct. Figures quotes are approximate only and financial information is provided without reference to the possible Impact of GST. Interested parties should make their own enquires and seek independent advice before acting. Subject and statutory limitation on it's ability to do si, Fairfax Century 21 Mastracorp Commercial disclaims liability under any cause of action including negligence for any loss arising from reliance upon this document. This document is nnot an offer or part of a contract of sale or lease.

# Fairfax Century 21 Mastracorp Commercial

Fairfax Century 21 Mastracorp Commercial (BEVERLEY)  
81 Ledger Road, BEVERLEY SA

## Property Area

Building Area :	-
Land Area :	907 Square Metres
Hardstand :	-
Car :	-

## Tenancy Details

### Tenancy :

Office Showroom :	-
Mezzanine :	375 Square Metres
Warehouse :	-
Other :	-
Total Floor Area :	375 Square Metres

## Rentals Detail

Annual Rental :	-
Rate per sqm :	-
Lease Term :	-
Rent Review :	-
Outgoings :	Paid by Tenant
Currently Tenanted :	No
Zoning :	-

## Description & Comments :

- Area 375m2, approximately - Office/Warehouse - Workshop - Ample car parking - Close to all main road - suit many uses OPPORTUNITY NOT BE MISSED CONTACT PASQUALE MASTRANGELO TODAY 0409 465 863



## Contacts

**Pasquale Mastrangelo**  
pasquale@mastracorp.com.au

## All Prices are exclusive of GST

Disclaimer. Information in this document may have been provided to Fairfax Century 21 Mastracorp Commercial Adelaide by other people and we don't warrant it is accurate or correct. Figures quotes are approximate only and financial information is provided without reference to the possible Impact of GST. Interested parties should make their own enquires and seek independent advice before acting. Subject and statutory limitation on it's ability to do si, Fairfax Century 21 Mastracorp Commercial disclaims liability under any cause of action including negligence for any loss arising from reliance upon this document. This document is nnot an offer or part of a contract of sale or lease.

# Fairfax Century 21 Mastracorp Commercial

**Fairfax Century 21 Mastracorp Commercial (WELLAND)**  
u7-113 Welland, WELLAND SA

## Property Area

Building Area :	-
Land Area :	180 Square Metres
Hardstand :	-
Car :	-

## Tenancy Details

### Tenancy :

Office Showroom :	-
Mezzanine :	113 Square Metres
Warehouse :	-
Other :	-
Total Floor Area :	113 Square Metres

## Rentals Detail

Annual Rental :	-
Rate per sqm :	-
Lease Term :	-
Rent Review :	-
Outgoings :	Paid by Tenant
Currently Tenanted :	No
Zoning :	-

## Description & Comments :

Property Description Key Investment Highlights: 113 m2 Space -OFFICE/ WAREHOUSE/ WORKSHOP 81 m2 of YARD Great Exposure Ample Car-parking Close to all facilities Invest Now Occupier in the future. Contact Land Agent PASQUALE MASTRANGELO - 0409 465 863 NICOLAS MASTRANGELO - 0401 790 753



## Contacts

**Pasquale Mastrangelo**  
pasquale@mastracorp.com.au



## All Prices are exclusive of GST

Disclaimer. Information in this document may have been provided to Fairfax Century 21 Mastracorp Commercial Adelaide by other people and we don't warrant it is accurate or correct. Figures quotes are approximate only and financial information is provided without reference to the possible impact of GST. Interested parties should make their own enquires and seek independent advice before acting. Subject and statutory limitation on it's ability to do si, Fairfax Century 21 Mastracorp Commercial disclaims liability under any cause of action including negligence for any loss arising from reliance upon this document. This document is nnot an offer or part of a contract of sale or lease.

# Fairfax Century 21 Mastracorp Commercial

**Fairfax Century 21 Mastracorp Commercial (LONSDALE)**  
100 O'Sullivan Beach Road, LONSDALE SA

## Property Area

Building Area :	-
Land Area :	4131 Square Metres
Hardstand :	-
Car :	-

## Tenancy Details

### Tenancy :

Office Showroom :	-
Mezzanine :	4131 Square Metres
Warehouse :	-
Other :	-
Total Floor Area :	4131 Square Metres

## Rentals Detail

Annual Rental :	-
Rate per sqm :	-
Lease Term :	-
Rent Review :	-
Outgoings :	Paid by Tenant
Currently Tenanted :	No
Zoning :	-

## Description & Comments :

Excellent vacant block in a industrial/commercial estate, with a rare offering of over 4131 sqm (approx.) of land with Exposure to O&S Sullivan Beach Road. Zoning: Industrial  
GST will be payable on the sale of the above land sale transaction. CONTACT PASQUALE MASTRANGELO TODAY!!

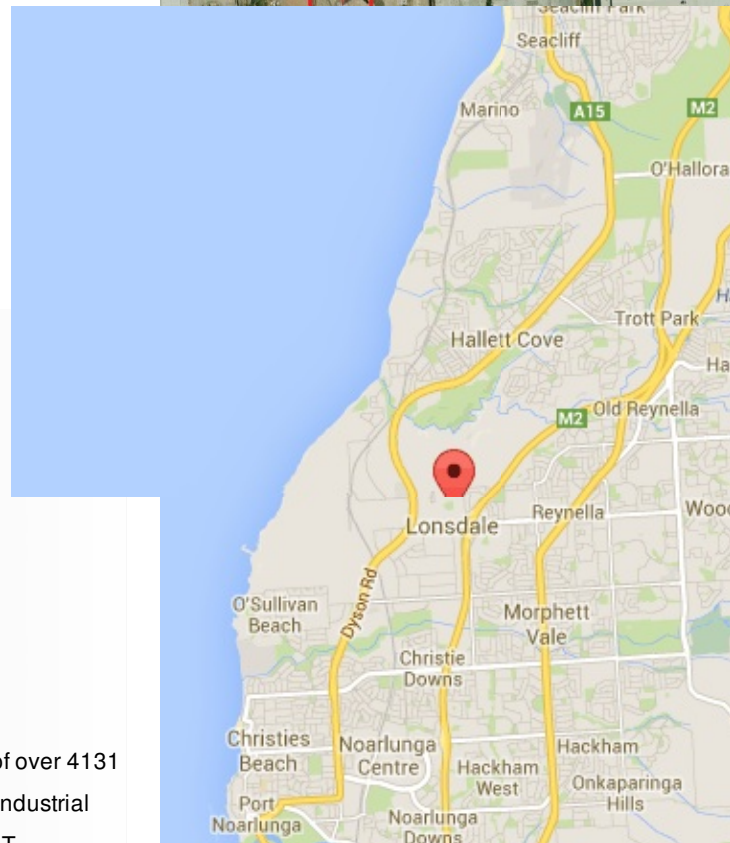

## Contacts

**Pasquale Mastrangelo**

pasquale@mastracorp.com.au

## All Prices are exclusive of GST

Disclaimer. Information in this document may have been provided to Fairfax Century 21 Mastracorp Commercial Adelaide by other people and we don't warrant it is accurate or correct. Figures quotes are approximate only and financial information is provided without reference to the possible Impact of GST. Interested parties should make their own enquires and seek independent advice before acting. Subject and statutory limitation on it's ability to do si, Fairfax Century 21 Mastracorp Commercial disclaims liability under any cause of action including negligence for any loss arising from reliance upon this document. This document is nnot an offer or part of a contract of sale or lease.

# Fairfax Century 21 Mastracorp Commercial

**Fairfax Century 21 Mastracorp Commercial (ADELAIDE)**  
231-243 Waymouth Street, ADELAIDE SA

## Property Area

Building Area :	-
Land Area :	2646 Square Metres
Hardstand :	-
Car :	-

## Tenancy Details

### Tenancy :

Office Showroom :	-
Mezzanine :	-
Warehouse :	-
Other :	-
Total Floor Area :	-

## Rentals Detail

Annual Rental :	-
Rate per sqm :	-
Lease Term :	-
Rent Review :	-
Outgoings :	Paid by Tenant
Currently Tenanted :	No
Zoning :	-

## Description & Comments :

Available area of 2,646 sqm approximately. Has a two street frontage to Waymouth and Crowther Streets on 6 separate titles with approvals for a 17 story building, offering both Commercial and Residential development. Opportunity not to be missed, contact Pasquale Mastrangelo on mobile 0409 465 863



## Contacts

**Pasquale Mastrangelo**  
pasquale@mastracorp.com.au

## All Prices are exclusive of GST

Disclaimer. Information in this document may have been provided to Fairfax Century 21 Mastracorp Commercial Adelaide by other people and we don't warrant it is accurate or correct. Figures quotes are approximate only and financial information is provided without reference to the possible Impact of GST. Interested parties should make their own enquires and seek independent advice before acting. Subject and statutory limitation on it's ability to do si, Fairfax Century 21 Mastracorp Commercial disclaims liability under any cause of action including negligence for any loss arising from reliance upon this document. This document is nnot an offer or part of a contract of sale or lease.

# Fairfax Century 21 Mastracorp Commercial

**Fairfax Century 21 Mastracorp Commercial (ADELAIDE)**  
184 HUTT STREET, ADELAIDE SA

## Property Area

Building Area :	-
Land Area :	185 Square Metres
Hardstand :	-
Car :	-

## Tenancy Details

### Tenancy :

Office Showroom :	-
Mezzanine :	339 Square Metres
Warehouse :	-
Other :	-
Total Floor Area :	339 Square Metres

## Rentals Detail

Annual Rental :	-
Rate per sqm :	-
Lease Term :	-
Rent Review :	-
Outgoings :	Paid by Tenant
Currently Tenanted :	No
Zoning :	-

## Description & Comments :

Century 21 Mastracorp & Commercial are pleased to offer for sale this prominent location investment opportunity. Features to mention include: Total Building Area of 339sqm\* distributed over two levels Ground Floor Tenant: Rimax Nominees Pty Ltd Use: Retail (Newsagency) Passing Rental: \$54,706 + Outgoings + GST Lease Term: 5 + 5 years (commenced 1/7/2011) Annual Review Method: C.P.I increases Renewal Method (option):Market Review First Floor Tenant: Grease & Oil Agencies Pty Ltd Use: Office Passing Rental: \$28,000 + Outgoings + GST Lease Term: 4+2+3+2 (commenced 1/1/2014) Annual Review Method: C.P.I increases Renewal Method (option):Market Review Total Rental Income: \$82,706 + Outgoings + GST Rear access via Corryton Street More information to come and included in this advertisement Inspection a Must! Call for more information CONTACT AGENTS NICOLAS MASTRANGELO - 0401790753 PASQUALE MASTRANGELO - 0409465863



## Contacts

**Pasquale Mastrangelo**  
pasquale@mastracorp.com.au

## All Prices are exclusive of GST

Disclaimer. Information in this document may have been provided to Fairfax Century 21 Mastracorp Commercial Adelaide by other people and we don't warrant it is accurate or correct. Figures quotes are approximate only and financial information is provided without reference to the possible impact of GST. Interested parties should make their own enquires and seek independent advice before acting. Subject and statutory limitation on it's ability to do so, Fairfax Century 21 Mastracorp Commercial disclaims liability under any cause of action including negligence for any loss arising from reliance upon this document. This document is not an offer or part of a contract of sale or lease.

# Fairfax Century 21 Mastracorp Commercial

**Fairfax Century 21 Mastracorp Commercial (RIDGEHAVEN)**  
11 Jennifer Avenue, RIDGEHAVEN SA

## Property Area

Building Area :	-
Land Area :	-
Hardstand :	-
Car :	-

## Tenancy Details

### Tenancy :

Office Showroom :	-
Mezzanine :	773 Square Metres
Warehouse :	-
Other :	-
Total Floor Area :	773 Square Metres

## Rentals Detail

Annual Rental :	-
Rate per sqm :	-
Lease Term :	-
Rent Review :	-
Outgoings :	Paid by Tenant
Currently Tenanted :	No
Zoning :	-

## Description & Comments :

• High clearance dual roller-door side access to an open 187sqm Workshop •  
• Natural sky-lighting with additional industrial lighting throughout the main workshop •  
• Office/ lunchroom with kitchen amenities and wash basin • Main bathroom with  
Shower + additional toilet • 6m x 3.3m mezzanine • 78sqm rear canopy for the  
extra storage • Front colour bond lock-up gate Council Area: City of Tee Tree Gully  
Zone: LIN'4 (Light Industrial) Site Area: 773sqm (approx.) Frontage: 22.86sqm(approx.)



## Contacts

**Pasquale Mastrangelo**  
pasquale@mastracorp.com.au

---

## **All Prices are exclusive of GST**

Disclaimer. Information in this document may have been provided to Fairfax Century 21 Mastracorp Commercial Adelaide by other people and we don't warrant it is accurate or correct. Figures quotes are approximate only and financial information is provided without reference to the possible Impact of GST. Interested parties should make their own enquires and seek independent advice before acting. Subject and statutory limitation on it's ability to do si, Fairfax Century 21 Mastracorp Commercial disclaims liability under any cause of action including negligence for any loss arising from reliance upon this document. This document is nnot an offer or part of a contract of sale or lease.