



**Peel**  
Business Park

Nambeelup,  
Western Australia



## Stage 1 in the Peel Business Park, Nambeelup will deliver flexible lots for the businesses of tomorrow.

### BENEFITS

- Land priced from \$99/sqm ex GST.
- Total of 10,364sqm available.
- Fully serviced lots with gas, water, waste water and NBN are available.
- Australia's first renewable energy industrial microgrid will save around 30% on energy bills compared to regulated bundled tariffs.
- Located in the Shire of Murray approximately 10kms North East of the Mandurah City Centre.
- Easy access to the Kwinana Freeway.
- Accessible to the ports of Kwinana, Fremantle and Bunbury.
- Opportunity to secure development approvals prior to titles.

With new innovations in equipment, infrastructure and processes, the focus for Peel Business Park is on technology driven agri-food and agri-processing operators, as well as ancillary light, general transport and support industries.



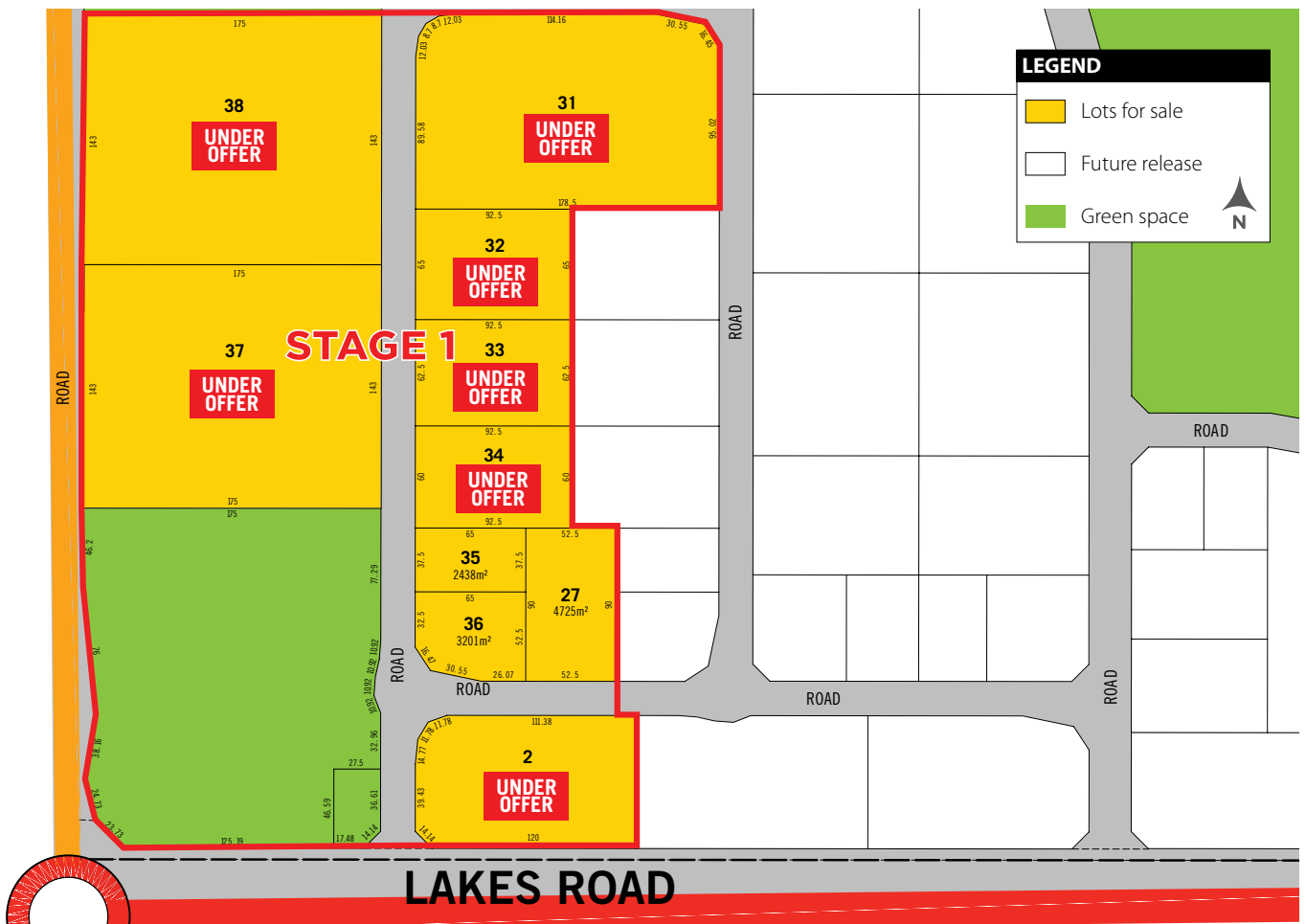

Lot#	Land Size	Land Use	Price (ex. GST)	\$/sqm (ex. GST)
2	10,008sqm	Service Commercial	Under Offer	
27	4,725sqm	Light Industrial	\$470,000	\$99/sqm
31	20,204sqm	Micro-grid	Under Offer	
32	6,013sqm	Light Industrial	Under Offer	
33	5,781sqm	Light Industrial	Under Offer	
34	5,550sqm	Light Industrial	Under Offer	
35	2,438sqm	Light Industrial	\$320,000	\$131/sqm
36	3,201sqm	Light Industrial	\$390,000	\$122/sqm
37	25,025sqm	Light Industrial	Under Offer	
38	25,025sqm	Agri-innovation	Under Offer	

Enquire for stage 1 lots listed above or register interest in stage 2 with CBRE today.

## CBRE

Agri-business sales Phil Melville [phil.melville@cbre.com.au](mailto:phil.melville@cbre.com.au) +61 488 203 088

Commercial and Industrial sales Jarrad Grierson [jarrad.grierson@cbre.com.au](mailto:jarrad.grierson@cbre.com.au) +61 413 242 240

[developmentwa.com.au/peelbusinesspark](http://developmentwa.com.au/peelbusinesspark)

Disclaimer: The information contained in this document is in good faith; however, neither DevelopmentWA nor any of its directors, agents or employees give any warranty of accuracy nor accepts any liability as result of a reliance upon the information, advice, statement or opinion contained in this document. This disclaimer is subject to any contrary legislative provisions. © DevelopmentWA 2019. LC 4704 10/2019